



## ADDENDUM #1

**PROJECT:** Woodbury Avenue Signal Interconnect  
NHDOT Project No. 29781  
Federal Aid Project No. X-A004(304)  
City Project No. 22002

**DATE:** May 19, 2017

**RE:** Granite St Luminaire & MA Rotation

**CITY BID NO.:** 51-17

---

To: Bidders and All Others to Whom Bidding Documents have been issued

All items in this Addendum shall supersede or clarify the Bidding Documents and Plans as originally issued. The cost of the Work of all Trades affected by the changes in this Addendum shall be included in the Base Bid or Alternatives, on the revised Proposal Form, as applicable.

This Addendum forms a part of the Contract Documents. It supplements and/or modifies them as follows:

### **ITEM ADDITION (non-question)**

**Item No. 1** - *Woodbury Avenue at Granite Street* – The Bidder/Contractor shall furnish new and/or remove existing items at the intersection of Woodbury Avenue at Granite Street as originally shown on PS&E Design Plans dated April 17, 2017. The modifications are depicted on attached Addendum #1 Plan (8.5"x11") and include:

- Part of Item 616.196 (U) - Rotate "PROP TS POLE & 35' MAST ARM" at STA 64+17 RT 27'
- Part of Item 616.196 (U) – Remove part of item "PROP 8' TS POST ON CONC FDN" at STA 64+49 LT 33' from plans in lieu of proposed light pole (LP)
  - TS equipment will be retained on proposed LP
- Item 625.52 – Add "PROP 20' LP ON CONC FDN" at STA 64+50 LT 33'
- Item 625.621 – Remove and Reset "LUMINAIRE" to STA 64+50 LT 33'
- Item 625.622 – Remove and Stack "EXIST LP" at STA 64+63 LT 24'

Find attached revised Proposal Form



TEC, Inc.  
www.TheEngineeringCorp.com

65 Glenn Street | 169 Ocean Boulevard  
Lawrence, MA 01843 | Unit 101, PO Box 249  
Hampton, NH 03842  
t: (978) 794-1792

PROJECT:	WOODBURY AVENUE TRAFFIC SIGNAL INTERCONNECT	PROJECT NO.:	T0543
LOCATION:	PORTSMOUTH, NEW HAMPSHIRE	DATE:	05/19/2017
TITLE:	ADDENDUM #1: GRANITE ST LUMINAIRE & MA ROTATION	SCALE:	1" = 30'

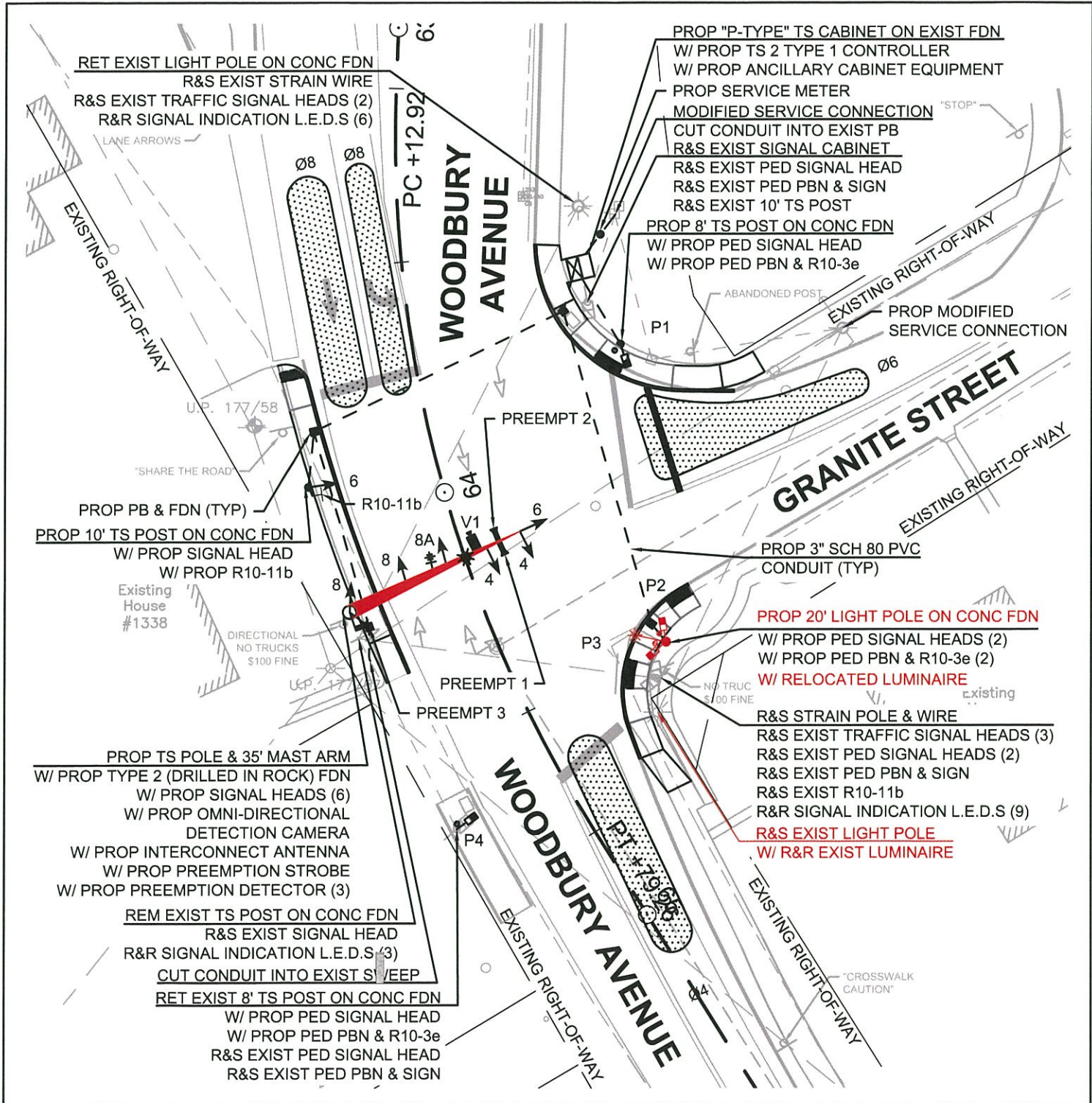

T:\T0543\CAD\Highway\Construction\SK's\T0543\_Traffic Signal Plans\_Addendum 1.dwg 5/19/2017 11:18:59 AM

**PROPOSAL FORM**

**Woodbury Avenue Traffic Signal Interconnect Project**

CITY OF PORTSMOUTH, N.H.

To the City of Portsmouth, New Hampshire, herein called the Owner.

The undersigned, as Bidder, herein referred to as singular and masculine declares as follows:

1. All interested in the Bid as Principals are named herein.
2. This bid is not made jointly, or in conjunction, cooperation or collusion with any other person, firm, corporation, or other legal entity;
3. No officer, agent or employee of the Owner is directly or indirectly interested in this Bid.
4. The bidder has carefully examined the sites of the proposed work and fully informed and satisfied himself as to the conditions there existing, the character and requirements of the proposed work, the difficulties attendant upon its execution and the accuracy of all estimated quantities stated in this Bid, and the bidder has carefully read and examined the Drawings, Agreement, Specifications and other Contract Documents therein referred to and knows and understands the terms and provisions thereof;
5. The bidder understands that the quantities of work calculated in the Bid or indicated on the Drawings or in the Specifications or other Contract Documents are approximate and are subject to increase or decrease or deletion as deemed necessary by the Director of Public Works. Any such changes will not result in or be justification for any penalty or increase in contract prices; and agrees that, if the Bid is accepted the bidder will contract with the Owner, as provided in the Contract Documents, this Bid Form being part of said Contract Documents, and that the bidder will supply or perform all labor, services, plant, machinery, apparatus, appliances, tools, supplies and all other activities required by the Contract Documents in the manner and within the time therein set forth, and that the bidder will take in full payment therefore the following item prices, to wit:

ITEM #	EST. QTY	UNITS	ITEM DESCRIPTION AND UNIT PRICE IN WORDS	UNIT PRICE IN FIGURES	ITEM TOTAL IN FIGURES
202.6	450	FT	Curb Removal for Salvage	\$ _____	\$ _____
203.1	775	CY	Common Excavation	\$ _____	\$ _____
214	1	U	Fine Grading	\$ _____	\$ _____

<b>ITEM #</b>	<b>EST. QTY</b>	<b>UNITS</b>	<b>ITEM DESCRIPTION AND UNIT PRICE IN WORDS</b>	<b>UNIT PRICE IN FIGURES</b>	<b>ITEM TOTAL IN FIGURES</b>
304.3	15	CY	Crushed Gravel (F)	\$_____	\$_____
403.12	200	Tons	Hot Bituminous Pavement, Hand Method	\$_____	\$_____
604.0007	10	EA	Polyethylene Liner	\$_____	\$_____
604.4	25	LF	Reconstructing / Adjusting Catch Basin & Drop Inlet	\$_____	\$_____
608.26	950	SY	6" Concrete Sidewalk	\$_____	\$_____
608.257	185	SY	Median Island (Broom Finish in 8" Cement Concrete)	\$_____	\$_____
608.54	55	SY	Detectable Warning Devices, Cast Iron	\$_____	\$_____
609.01	75	LF	Straight Granite Curb	\$_____	\$_____
609.02	225	LF	Curved Granite Curb	\$_____	\$_____
609.21	130	LF	Straight Granite Sloped Curb	\$_____	\$_____
609.23	20	LF	Curved Granite Sloped Curb	\$_____	\$_____

<b>ITEM #</b>	<b>EST. QTY</b>	<b>UNITS</b>	<b>ITEM DESCRIPTION AND UNIT PRICE IN WORDS</b>	<b>UNIT PRICE IN FIGURES</b>	<b>ITEM TOTAL IN FIGURES</b>
609.5	1,800	LF	Reset Granite Curb	\$ _____	\$ _____
614.511	20	EA	Concrete Pull Box 14"	\$ _____	\$ _____
614.519	48	EA	Reset Concrete Pull Box	\$ _____	\$ _____
614.73118	775	LF	3" PVC Conduit, Schedule 80	\$ _____	\$ _____
615.0301	510	SF	Traffic Sign Type C	\$ _____	\$ _____
615.032	60	EA	Traffic Sign Type C, Breakaway Mounts (F)	\$ _____	\$ _____
615.033	45	EA	Removing Traffic Sign, Type C	\$ _____	\$ _____
616.191	1	U	Alterations to Traffic Signals Location No. 1	\$ _____	\$ _____
616.192	1	U	Alterations to Traffic Signals Location No. 2	\$ _____	\$ _____
616.193	1	U	Alterations to Traffic Signals Location No. 3	\$ _____	\$ _____

<b>ITEM #</b>	<b>EST. QTY</b>	<b>UNITS</b>	<b>ITEM DESCRIPTION AND UNIT PRICE IN WORDS</b>	<b>UNIT PRICE IN FIGURES</b>	<b>ITEM TOTAL IN FIGURES</b>
616.194	1	U	Alterations to Traffic Signals Location No. 4	\$ _____	\$ _____
616.195	1	U	Alterations to Traffic Signals Location No. 5	\$ _____	\$ _____
616.196	1	U	Alterations to Traffic Signals Location No. 6	\$ _____	\$ _____
616.197	1	U	Alterations to Traffic Signals Location No. 7	\$ _____	\$ _____
618.61	120	HR	Uniformed Officers with Vehicle	\$ _____	\$ _____
618.7	240	HR	Flaggers	\$ _____	\$ _____
619.1	1	U	Maintenance of Traffic	\$ _____	\$ _____
625.52	1	U	Light Pole	\$ _____	\$ _____
625.621	1	U	Reset Luminaire	\$ _____	\$ _____
625.622	1	U	Remove Light Pole	\$ _____	\$ _____
632.0106	1,360	LF	Retroreflective Paint Pavement Marking, 6” Line	\$ _____	\$ _____

<b>ITEM #</b>	<b>EST. QTY</b>	<b>UNITS</b>	<b>ITEM DESCRIPTION AND UNIT PRICE IN WORDS</b>	<b>UNIT PRICE IN FIGURES</b>	<b>ITEM TOTAL IN FIGURES</b>
632.3112	5,700	LF	Retroreflective Thermoplastic Pavement Marking, 12” Line	\$_____	\$_____
632.3118	240	LF	Retroreflective Thermoplastic Pavement Marking, 18” Line	\$_____	\$_____
632.3124	400	LF	Retroreflective Thermoplastic Pavement Marking, 24” Line	\$_____	\$_____
632.32	700	SF	Retroreflective Thermoplastic Pavement Marking, Symbol or Word	\$_____	\$_____
632.911	2,300	LF	Obliterate Pavement Marking Line, 12” Wide & Under	\$_____	\$_____
632.912	950	LF	Obliterate Pavement Marking Line, Over 12” Wide	\$_____	\$_____
632.92	680	SF	Obliterate Pavement Marking, Symbol or Word	\$_____	\$_____
646.512	575	SY	Turf Establishment with Mulch, Tackifiers and Loam (F)	\$_____	\$_____
692	1	U	Mobilization	\$_____	\$_____

**TOTAL FOR PROJECT BASE BID AND **BASIS OF AWARD****

In Figures \$ \_\_\_\_\_

In Words \$ \_\_\_\_\_



**PROPOSAL FORM FOR ADDITIONAL/ALTERNATIVE #1 BID  
CONSTRUCTION ITEMS**

**It is mandatory to fill out this section as well.**

The Add Alternate #1 bid has been included for the application of paint pavement markings, as opposed to a combination of thermoplastic and paint pavement markings in the base bid, throughout the project should the City's concurrent pavement resurfacing project along Woodbury Avenue not occur until a time subsequent to the project under this cover.

ITEM #	EST. QTY	UNITS	ITEM DESCRIPTION AND UNIT PRICE IN WORDS	UNIT PRICE IN FIGURES	ITEM TOTAL IN FIGURES
632.0112	5,700	LF	Retroreflective Paint Pavement Marking, 12" Line	\$ _____	\$ _____
632.0118	240	LF	Retroreflective Paint Pavement Marking, 18" Line	\$ _____	\$ _____
632.0124	400	LF	Retroreflective Paint Pavement Marking, 24" Line	\$ _____	\$ _____
632.02	700	SF	Retroreflective Paint Pavement Marking, Symbol or Word	\$ _____	\$ _____

**TOTAL FOR PROJECT ADDITIONAL/ALTERNATIVE BID #1**

In Figures \$ \_\_\_\_\_

In Words \$ \_\_\_\_\_

**To Bidder:**

The City reserves the right, after bid opening and prior to award of the contract, to modify the amount of the work in the event that bids exceed budgeted amounts and/or easements and agreements from one or more impacted property owners are not received.

It is the intention of this contract that the items listed above describe completely and thoroughly the entirety of the work as shown on the plans and as described in the specifications. All other items required to accomplish the above items are considered to be subsidiary work, unless shown as a pay item.

The undersigned agrees that for extra work, if any, performed in accordance with the terms and provisions of the Contract Documents, the bidder will accept compensation as stipulated therein.

Date:

\_\_\_\_\_  
Company

By: \_\_\_\_\_  
Signature

\_\_\_\_\_  
Business Address

Title: \_\_\_\_\_

\_\_\_\_\_  
City, State, Zip Code

Telephone: \_\_\_\_\_

All Bids are to be submitted on this form and in a sealed envelope, plainly marked on the outside with the Bidder's name and address and the Project name as it appears at the top of the Proposal Form.

We certify that the Company is currently pre-qualified with the State of New Hampshire for Road Construction.

By: \_\_\_\_\_  
Signature & Title

\_\_\_\_\_  
Date