

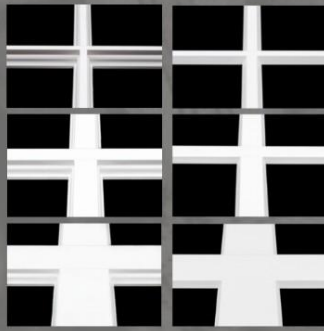

Historic Accuracy/Patented Design

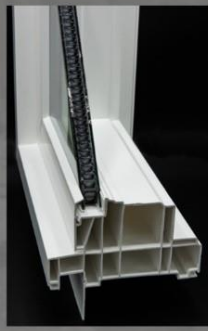

Our Patented 1854 external Ovolo sticking (left column) and internal Historic Putty Bead (right column) muntin bars are available in 3/8", 1 1/8" and 2 1/4".



Historic Putty Bead (internal) and Ovolo sticking (external) are incorporated into the Casement Frame and Sash profiles for 3/4" Glazed windows.



Historic accuracy is maintained with the joinery of our 5/4 x 3/4" Flat (left) Staff Bead Brickmould (above), or 4 1/2" Banded (below) with our Historic Sill Nose.



Our Patented Sash Glazed Double Hung Picture Window provides the exact same sight lines maintained within the same glass planes as our operable Double Hung units. This provides an aesthetic improvement over current window designs. Our Historic 1854 Ovolo Sticking (on 3/4" glazed sash), Putty Bead contours as well as the radius edge on the Sill Dam maintain the historic accuracy. With Performance Grade 50 ratings the Sanford Hills is as rugged as it is beautiful.

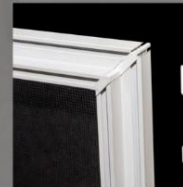

A wise man once said, "When you set out to design a window, start with the screen." We took this advice to heart and came up with a screen design so breakthrough, it's patented. This is, quite simply, the best window screen design on the market, whether it's for Double Hung or Casement.

Double-Hung Windows

Traditional, classic, durable — double-hungs give you all of that plus energy efficiency and peace of mind. Top and bottom sash operate smoothly allowing you to control air flow, and they both tilt-in for easy cleaning and care. Grilles can be added to further enhance the traditional look of your home.



Used singly, or factory mullied with transoms or other fixed or hung units to add a dramatic accent to your home's appearance, while providing a brighter, more open interior.

Single-Hung Windows

Our single-hung windows are built with a fixed top sash, while the lower sash moves up and down to allow ventilation.

In addition, the bottom sash conveniently tilts-in for easy cleaning.



Structural interlock at meeting rails provides an additional layer of protection and weather resistance.

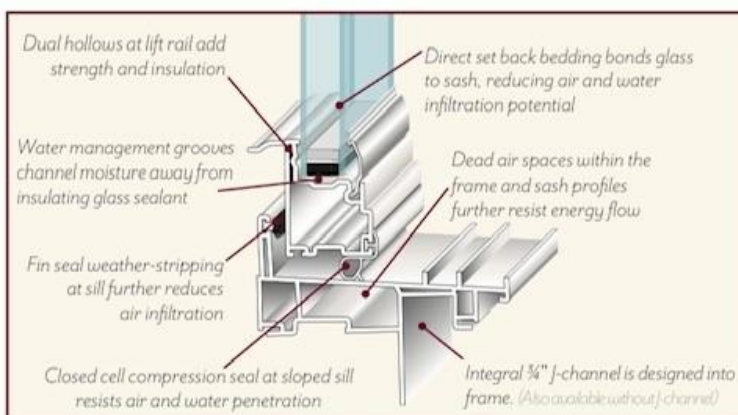



Actual Mathews Brothers window approved at 12/13/23 HDC meeting



Mathews Brothers

Tel:
Fax:
Email:



Customer
QUOTATION

BILL TO:

SHIP TO:

QUOTE #	STATUS	CUSTOMER PO#	DATE QUOTED
684206	None		4/10/2024 10:50:07 AM
QUOTED BY	TERMS	PROJECT NAME	QUOTE NAME
Stott Kenny		66 South Street PHASE II	KS-Amarosa PHASE II

LINE #	QTY	SUB-LINES
--------	-----	-----------

100

1 X

2

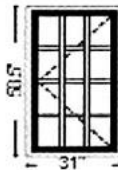

LINE #	DESCRIPTION	QTY	LIST PRICE	NET PRICE	EXTD. PRICE
--------	-------------	-----	------------	-----------	-------------

100-1

1 X

\$1,369.25

\$894.55

\$1,789.10

Sanford Hills Dual Pane Casement
 31 X 58.5 Unit Size, Left Operating, Black Interior,
 Extruded White Exterior Frame, Black Exterior Sash, Dual
 Pane Low E Argon, PG65, 12 Lite Contoured GBG, Black
 Int/Black Ext Grille in Airspace, Special Hinge, 21.5 X
 51.625 Clear Opening, 7.707 SQFT, No Window Opening
 Control Device, Black Handle & Lock, Fiberglass Mesh
 Black Screen Shipped Loose
 w/J-Channel, 3-1/2" Flat Matches Exterior Frame Color, w/
 Nailing Fin, w/Historical Sill Nose, w/ Installation Screws
 Unit 1: UFactor: 0.24, SHG: 0.22, VLT: 0.42, CR: 61

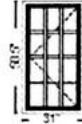

Opening: 31.5" X 59"

O.S.M.: 31" X 58.5"

Tag: EGRESS

LINE #	DESCRIPTION	QTY	LIST PRICE	NET PRICE	EXTD. PRICE
--------	-------------	-----	------------	-----------	-------------

100-2 Screen1

1 X

\$0.00

\$0.00

\$0.00

Fiberglass Mesh Black Insert Screen Shipped Loose

Opening: 0" X 0"

O.S.M.:

Tag: None Assigned

QUOTE #	STATUS	CUSTOMER PO#	DATE QUOTED
684206	None		4/10/2024 10:50:07 AM
QUOTED BY	TERMS	PROJECT NAME	QUOTE NAME
Stott Kenny		66 South Street PHASE II	KS-Amarosa PHASE II

LINE #	QTY	SUB-LINES
200	4	2

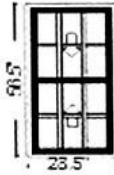

LINE #	DESCRIPTION	QTY	LIST PRICE	NET PRICE	EXTD. PRICE
--------	-------------	-----	------------	-----------	-------------

200-1
 Sanford Hills Dual Pane Double Hung
 28.5 X 56.5 Unit Size, Black Interior, Extruded White Exterior Frame, Black Exterior Sash, Exterior Pocket Cover, Dual Pane Low E Argon, PG50, 6/6 Lite Contoured GBG, Black Int/Black Ext Grille in Airspace, No Lift Rail, 23.187 X 23.25 Clear Opening, 3.743 SQFT, Hidden Tilt Latch, Dual Black Robo-Tilt Lock, No Window Opening Control Device, Fiberglass Mesh White Half Screen Shipped Loose w/J-Channel, 3-1/2" Flat Matches Exterior Frame Color, w/ Nailing Fin, w/Historical Sill Nose, w/ Installation Screws
 Unit 1: UFactor: 0.27, SHG: 0.27, VLT: 0.5, CR: 58

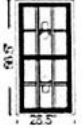

Opening: 29" X 57"
 O.S.M.: 28.5" X 56.5" Tag: None Assigned

LINE #	DESCRIPTION	QTY	LIST PRICE	NET PRICE	EXTD. PRICE
--------	-------------	-----	------------	-----------	-------------

200-2 Screen1
 Insert Half Screen Shipped Loose

Opening: 0" X 0"
 O.S.M.: Tag: None Assigned

LINE #	DESCRIPTION	QTY	LIST PRICE	NET PRICE	EXTD. PRICE
--------	-------------	-----	------------	-----------	-------------

300-1
 Sanford Hills Dual Pane Awning
 26.5 X 18 Unit Size, Operating, Black Interior, Extruded White Exterior Frame, Black Exterior Sash, Dual Pane Low E Argon, PG80, 4 Lite Contoured GBG, Black Int/Black Ext Grille in Airspace, Black Handle & Lock, Fiberglass Mesh Black Screen Applied
 w/J-Channel, 3-1/2" Flat Matches Exterior Frame Color, w/ Nailing Fin, w/Historical Sill Nose, w/ Installation Screws
 Unit 1: UFactor: 0.24, SHG: 0.22, VLT: 0.42, CR: 59

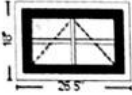

Opening: 27" X 18.5"
 O.S.M.: 26.5" X 18" Tag: None Assigned

QUOTE #	STATUS	CUSTOMER PO#	DATE QUOTED
684206	None		4/10/2024 10:50:07 AM
QUOTED BY	TERMS	PROJECT NAME	QUOTE NAME
Stott Kenny		66 South Street PHASE II	KS-Amarosa PHASE II

LINE #	QTY	SUB-LINES
200	4	2

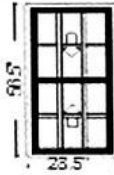

LINE #	DESCRIPTION	QTY	LIST PRICE	NET PRICE	EXTD. PRICE
--------	-------------	-----	------------	-----------	-------------

200-1
 Sanford Hills Dual Pane Double Hung
 28.5 X 56.5 Unit Size, Black Interior, Extruded White Exterior Frame, Black Exterior Sash, Exterior Pocket Cover, Dual Pane Low E Argon, PG50, 6/6 Lite Contoured GBG, Black Int/Black Ext Grille in Airspace, No Lift Rail, 23.187 X 23.25 Clear Opening, 3.743 SQFT, Hidden Tilt Latch, Dual Black Robo-Tilt Lock, No Window Opening Control Device, Fiberglass Mesh White Half Screen Shipped Loose w/J-Channel, 3-1/2" Flat Matches Exterior Frame Color, w/ Nailing Fin, w/Historical Sill Nose, w/ Installation Screws
 Unit 1: UFactor: 0.27, SHG: 0.27, VLT: 0.5, CR: 58

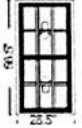

Opening: 29" X 57"
 O.S.M.: 28.5" X 56.5" Tag: None Assigned

LINE #	DESCRIPTION	QTY	LIST PRICE	NET PRICE	EXTD. PRICE
--------	-------------	-----	------------	-----------	-------------

200-2 Screen1
 Insert Half Screen Shipped Loose

Opening: 0" X 0"
 O.S.M.: Tag: None Assigned

LINE #	DESCRIPTION	QTY	LIST PRICE	NET PRICE	EXTD. PRICE
--------	-------------	-----	------------	-----------	-------------

300-1
 Sanford Hills Dual Pane Awning
 26.5 X 18 Unit Size, Operating, Black Interior, Extruded White Exterior Frame, Black Exterior Sash, Dual Pane Low E Argon, PG80, 4 Lite Contoured GBG, Black Int/Black Ext Grille in Airspace, Black Handle & Lock, Fiberglass Mesh Black Screen Applied
 w/J-Channel, 3-1/2" Flat Matches Exterior Frame Color, w/ Nailing Fin, w/Historical Sill Nose, w/ Installation Screws
 Unit 1: UFactor: 0.24, SHG: 0.22, VLT: 0.42, CR: 59

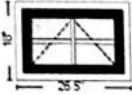

Opening: 27" X 18.5"
 O.S.M.: 26.5" X 18" Tag: None Assigned

QUOTE #	STATUS	CUSTOMER PO#	DATE QUOTED
684206	None		4/10/2024 10:50:07 AM
QUOTED BY	TERMS	PROJECT NAME	QUOTE NAME
Stott Kenny		66 South Street PHASE II	KS-Amarosa PHASE II

All Prices are net. Please review all quantities, specifications, and information for accuracy. Special orders can not be returned for credit. Signature implies acceptance of these specifications. Your order will not be processed without authorized signature.

SUB-TOTAL:	\$11,026.67
LABOR:	\$0.00
FREIGHT:	\$0.00
SALES TAX:	\$0.00
TOTAL:	\$11,026.67

Thank you for all of your efforts!

CUSTOMER SIGNATURE _____ DATE _____

We appreciate the opportunity to provide you with this quote!



66 South St. is not located directly on the street. The unit is in the back, located behind # 68, and is not visible from South Street.





We would like to replace broken fencing in backyard - With new fencing to match this fence in front yard

Amarosa Application for HDC Approval
 66 South St.

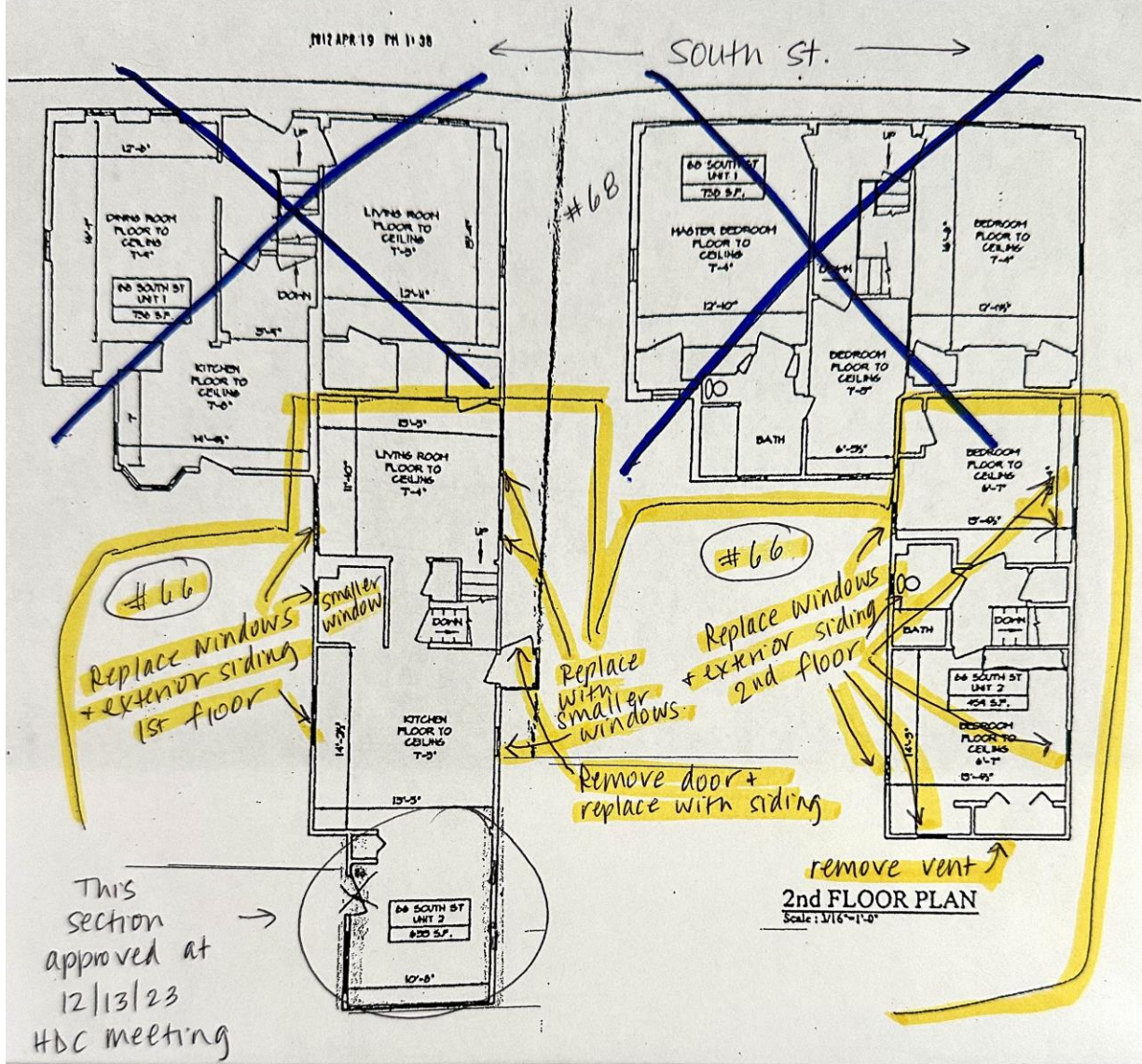

Materials - see attached photos / literature

Windows - Mathews Brothers as approved at 12/13/23 HDC meeting

siding - Lifespan Solid Select Pine
 * We have changed our siding choice based on 4/3/24 HDC meeting







Lifespan[®] Solid Select at a glance

Wood has long been the choice of builders. It is beautiful, versatile and easy to work with. However, wood in an exterior situation is also subject to rot, fungal decay and insect attack. With LIFESPAN SOLID SELECT pressure treated, primed boards, wood now comes with long-lasting durability and low-maintenance peace of mind.

Read more

LIFESPAN SOLID SELECT is protected with the combination of a pressure treatment using organic biocides to ward off insects and fungal decay, a proprietary water repellency system to maximize dimensional stability and an alkyd-based primer to provide superior durability against the elements. This allows LIFESPAN SOLID SELECT to be offered with a limited lifetime warranty against fungal decay and insect damage, including termites.

The raw material for LIFESPAN SOLID SELECT comprises high grade clear lumber produced from pruned radiata pine logs. These come only from renewable sources and we utilize leading technology and innovative techniques to maximize the recovery of logs into finished products and minimize waste in our mills.

LIFESPAN SOLID SELECT is manufactured in our Forest Stewardship Council[®] (FSC[®]) certified mills (FSC[®] SCS-COC-00199).

- Limited lifetime substrate warranty against fungal decay and insect damage, including termites
- Manufactured from solid high grade wood with no fingerjoints or knots
- Pressure treated with an EPA approved organic preservative, delivering treatment to the core
- Non-corrosive to fasteners
- FSC[®] certified
- Multi-layer protection resists water uptake and enhances dimensional stability
- Alkyd primer provides smooth defect-free surface ready for top-coating
- Suitable for exterior and interior needs
- Real wood!!



Real Wood. Redefined.

LIFESPAN[®] SOLID SELECT is a premium solid wood exterior trim product – offering a superior clean finish, outstanding performance, and the benefits of real wood.

 Limited lifetime warranty	 Clear grade lumber – no finger-joints or knots	 Superior durability against rot, fungal attack and insects
 Resists corrosion to nails and fastenings	 FSC [®] Certified – environmentally responsible	 Superior water resistance
 Long-term termite protection	 Real wood – a pleasure to work with	 Active ingredients registered with EPA

Now with CODIL[™] - our patented and proprietary resin stabilization additive

The advantages are clear

Sourced from New Zealand's renowned radiata pine forests, LIFESPAN[®] SOLID SELECT is made from only the highest quality, long-length clear boards. This superior product features an EPA-approved non-metallic preservative that protects against rot, fungal attack and insects (including termites). It also offers superior moisture resistance and resin stabilization – with a proprietary water repellent system, two coats of alkyd primer and patented resin stabilization additive CODIL[™]. This proven protection is backed by a limited lifetime warranty.

Combining outstanding durability with the beauty of real wood, LIFESPAN[®] SOLID SELECT is the choice for a lifetime.