

HDC

ADMINISTRATIVE APPROVALS

August 14, 2024

- | | | |
|----|------------------------|-----------------------|
| 1. | 195 Washington Street | -TBD |
| 2. | 229 Pleasant Street #3 | -Recommended Approval |
| 3. | 260 Marcy Street | -Recommended Approval |

1. 195 Washington Street -TBD

Background: The applicant is seeking approval for the installation of a walkway gate and driveway gate. The style of gate(s) and location have been approved. The applicant will show how the gates will be installed.

Staff Comment: TBD

Stipulations:

1. _____
2. _____
3. _____



Location of the double arched gate.



Location of the smaller arched walkway gate.



Example of the single aluminum arched walkway gate.



The pink lines indicate the locates of the (2) gates:

The larger double arched aluminum gate will be placed at the start of the driveway and will be 4ft. tall at the highest point. Below is a sample shown in white, the proposal would be for a black gate.



2. 229 Pleasant Street -Recommended Approval

Background: The applicant is seeking approval for the replacement of an existing basement window with a larger window to meet egress standards. This request is from the applicant's insurance provider.

Staff Comment: Recommend Approval

Stipulations:

1. _____
2. _____
3. _____

Full Service Insurance Protection for Financial Peace of Mind



196 York Street, P.O. Box 380
York, Maine 03909
207-363-7670
Fax: 207-363-1389
www.ellisinsuranceagency.com

May 17, 2024

Haven White Condominium Association
18 OSPREY CV
Greenland, NH 03840

RE: MMG Insurance Company
Business Owners Policy# BP13681645
Effective: 08/12/2023 -- 08/12/2024

Dear Beth,

Insurance Company underwriting requirements are that bedrooms in a basement location have two means of egress. Your unit currently only has one exit from the basement. As such, the company would require that a second means of egress be added in order for you to use that room as a bedroom. An egress window is acceptable.

If you have any questions about this, please do not hesitate to let me know.

Sincerely,

A handwritten signature in blue ink that reads "Jonel". The signature is fluid and cursive.

Jonel Thames Leake
Customer Service Agent
jleake@ellisinsuranceagency.com



Mathews Brothers

Tel:
Fax:
Email:



Customer
QUOTATION

BILL TO:

SHIP TO:

QUOTE #	STATUS	CUSTOMER PO#	DATE QUOTED
692298	None		5/16/2024 12:28:48 PM
QUOTED BY	TERMS	PROJECT NAME	QUOTE NAME
Amanda Henebury		webber	Portsmouth

LINE #	DESCRIPTION	QTY	LIST PRICE	NET PRICE	EXTD. PRICE
100-1		1	\$643.62	\$418.35	\$418.35

Walcott New Construction Casement
 31.5 X 38.75 Unit Size, Left Operating, White, Insul Low-E
 & Argon, 9 Lite Contoured, White Grille in Airspace,
 Special Hinge, 24.5 X 33.75 Clear Opening, 5.742 SQFT,
 No Window Opening Control Device, White Handle &
 Lock, White Screen Applied
 Drywall Return, 3/4" (All Four Sides), w/Nailing Flange, No
 J Channel, No Exterior Casing
 Unit 1: UFactor: 0.27, SHG: 0.27, VLT: 0.51, CR: 59



Opening: 32" X 39.25"
 O.S.M.: 31.5" X 38.75"

Tag: None Assigned

All Prices are net. Please review all quantities, specifications, and information for accuracy.
 Special orders can not be returned for credit. Signature implies acceptance of these
 specifications. Your order will not be processed without authorized signature.

SUB-TOTAL:	\$418.35
LABOR:	\$0.00
FREIGHT:	\$0.00
SALES TAX:	\$0.00
TOTAL:	\$418.35

Thank you for all of your efforts!

CUSTOMER SIGNATURE _____ DATE _____

We appreciate the opportunity to provide you with this quote!

Preferred Window

*
Note: Joist
run parallel
to window

32"

Existing 2x8 Fram

to window

Proposed

35"

39 1/2"

32"

Cut existing concrete 4 1/2"

New
4x4 sill
plate

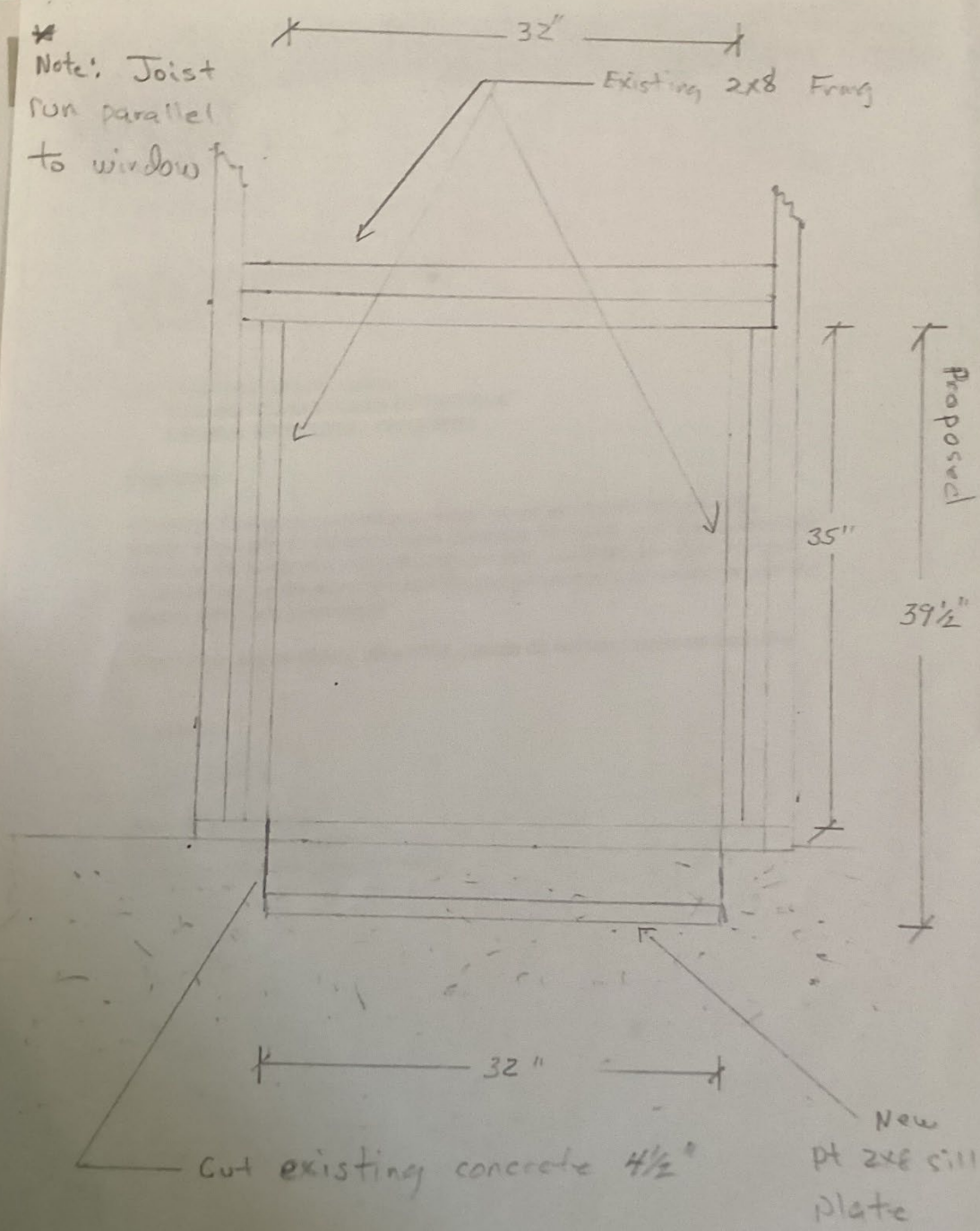





SOLD BY:
 Middleton Building Supply - Dover
 58 Old Rochester Rd
 Dover, NH 03820-2021
 Fax: 603-742-5528

SOLD TO:

CREATED DATE
5/16/2024

LATEST UPDATE
5/16/2024

OWNER
amanda henebury

Abbreviated Quote Report - Customer Pricing

QUOTE NAME	PROJECT NAME	QUOTE NUMBER	CUSTOMER PO#	TRADE ID
Webber	Portsmouth	5801626		

ORDER NOTES:

DELIVERY NOTES:

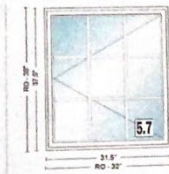

Item	Qty	Operation	Location	Unit Price	Ext. Price
100	1	Left	None Assigned	\$789.43	\$789.43

RO Size: 32" x 38" **Unit Size: 31 1/2" x 37 1/2"**

PSC 2' 7 1/2"X3' 1 1/2", Unit, 400 Series Casement, Installation Flange, White Exterior Frame, White Exterior Sash/Panel, Pine w/White - Painted Interior Frame, Left, Hinge for Widest Clear Opening, Dual Pane Low-E4 Standard Series Argon Fill Contour Finelight Grilles-Between-the-Glass 3 Wide, 3 High, Specified Equal Light Pattern, White, w/White, 3/4" Grille Bar, Traditional Trim Stop Profile Stainless Glass / Grille Spacer, Traditional Folding, White, White, Full Screen, Aluminum Wrapping: Interior Drywall Return Bead Pine / White - Vinyl Wrapped Narrow Complete Unit Extension Jambs, Factory Applied

Hardware: PSC Traditional Folding White PN:1361560
 Insect Screen 1: 400 Series Casement, PSC 31.5 x 37.5 Full Screen Aluminum White

Unit #	U-Factor	SHGC	ENERGY STAR	Clear Opening/Unit #	Width	Height	Area (Sq. Ft)
A1	0.28	0.29	NO	A1	25.6910	32.6480	5.82470

Optional Window

QUOTE# 5801626 DRAWING MFC24

EXTERIOR VIEW

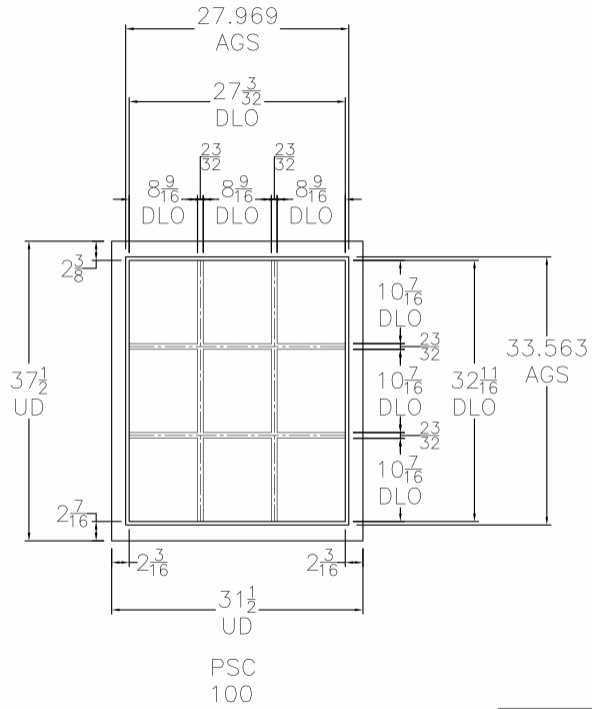
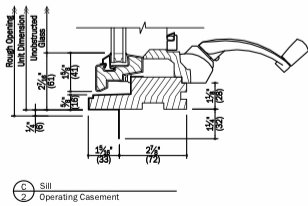
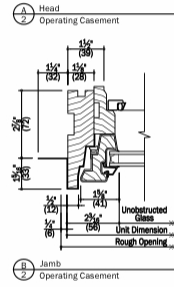
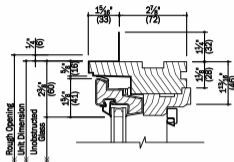

3/4" FINELIGHT

ANDERSEN
WINDOWS & DOORS

ANDERSEN, the Andersen symbol and the Andersen logo are registered trademarks of Andersen Corporation. All other trademarks are the property of their respective owners. © 2024 Andersen Corporation. All rights reserved. Andersen Corporation, 10000 Andersen Drive, Englewood, CO 80150. Andersen Corporation is an Equal Opportunity Employer. MFC 6.24.2024

MFC 6.24.2024



3. 260 Marcy Street

-Recommended Approval

Background: The applicant is seeking approval for the replacement of the existing wood picket fence with a metal fence.

Staff Comment: Recommend Approval

Stipulations:

1. _____
2. _____
3. _____

DOROW

Meeting Hill Rd

260
Marcy St

House
Front door

Covered Porch



4ft

21ft

Marcy St

4ft tall
fence

4ft 6inches

6ft stockade fence

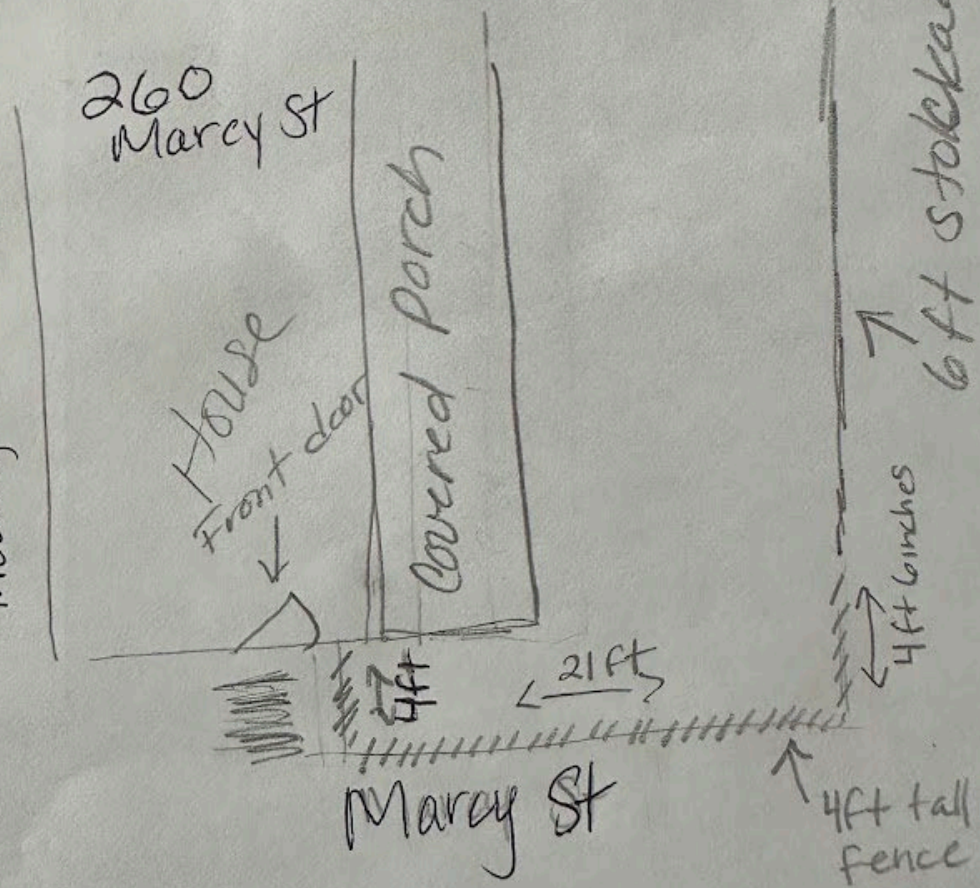





picket fence.

Failing wood



Example on Bow St.



Example



Example



Final Preference for Design