

Dear Samantha and Conservation Commission,

I'm seeking approval to fully remove our deck and replace it with stairs and a patio. We need to address some structural wood rot that has occurred between the deck and the home that is at risk of compromising the structural integrity of the home. The deck must be removed to access and fix the wood rot. We'd like to replace the deck with a patio to lean into the cottage woodland feel of our backyard. A patio will allow us to have a more seamless transition between living space and garden beds. As you'll see in my proposed plan, I'm expanding the garden bed originally along the deck to spill into the patio space to create a more organic feel. Since water management has been a concern with the home (leading to our wood rot problems), I've also added a gravel rain buffer along the foundation and a rain garden. The rain buffer, expanded garden bed, and rain garden will increase the permeable area (compared to the impermeable wooden deck). We're also awaiting a quote on permeable brick like pavers to increase the permeable surface area further. The area I'm requesting permission to modify is identical to the area of the deck. No other areas of the property will be disturbed.

Our lot already has a lot of native ferns, shrubs, and flowers. I am looking for more ways to add more, through expanding a garden bed and adding a rain garden but I'm primarily focused on removing the invasive plants on the property such as buckthorn.

Thank you for your consideration. Please let me know if you have any questions.

Regards,  
Sarah Cook  
(845)797-3136  
[scook26@gmail.com](mailto:scook26@gmail.com)

390 FW Hartford Dr.

Patio Proposal

# Project Proposal

We are proposing removing our deck (some has already been cut away due to structural rot on the foundation on the house that needed to be addressed urgently) and adding a patio of a smaller square footage than the deck along with a rain garden and some additional native plants. The patio will be made of water permeable material.

No trees or existing native vegetation will be disturbed.

# Lot Information



- Lot includes 8,340 sqft of wetlands (mostly dense forest).
- Lot includes 10,337 sqft of buffer zone.
- The buffer zone is made up of some trees, native shrubs, native ferns and some grassy patches.
- None of the buffer zone vegetation will be disturbed.

# Site Information

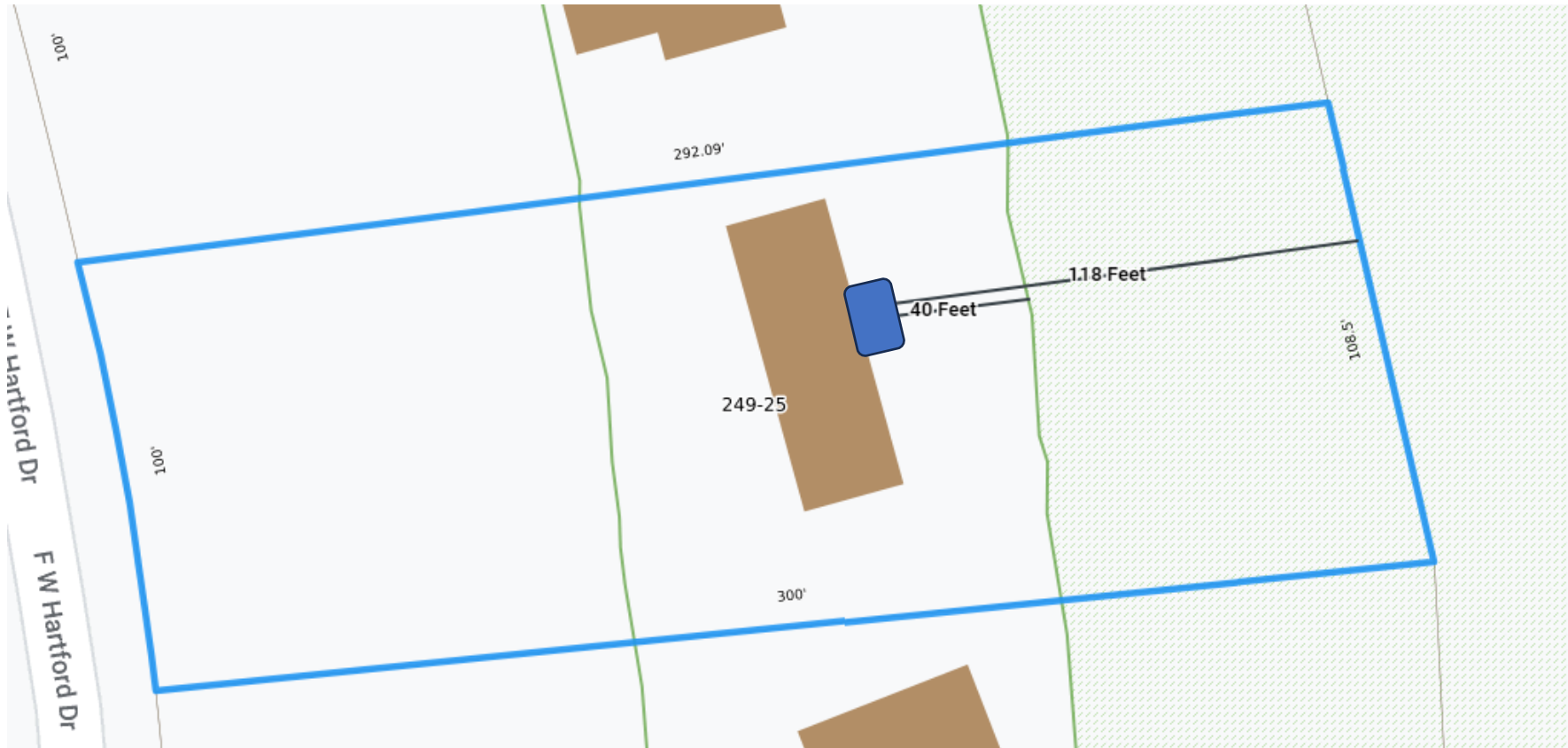

- Proposed Patio is located completely within the buffer zone
- It is 26.5ft from the edge of the wetlands and the start of the buffer zone
- Total area within the buffer zone to be disturbed is 246 sqft

# Existing Deck



- Existing deck is 14ft by 22.5ft, 315sqft.
- The deck is made of wood (impermeable) and will be completely removed.
- Deck is a safety concern, supported by a car jack and rotting away in many places.
- Deck had to be cut away in sections to repair structural wood rot along the foundation of the house.

# Proposed plan



- Includes replacing the deck area with 12ft by 20.5ft of permeable brick patio (246 sqft)
- Includes 1.5ft perimeter of gravel rain buffer along the house (which was previously covered by the deck)
- Proposed plan also includes installation of a rain garden and increasing the area of native ferns and flowers

# Proposed Plan compared to Deck

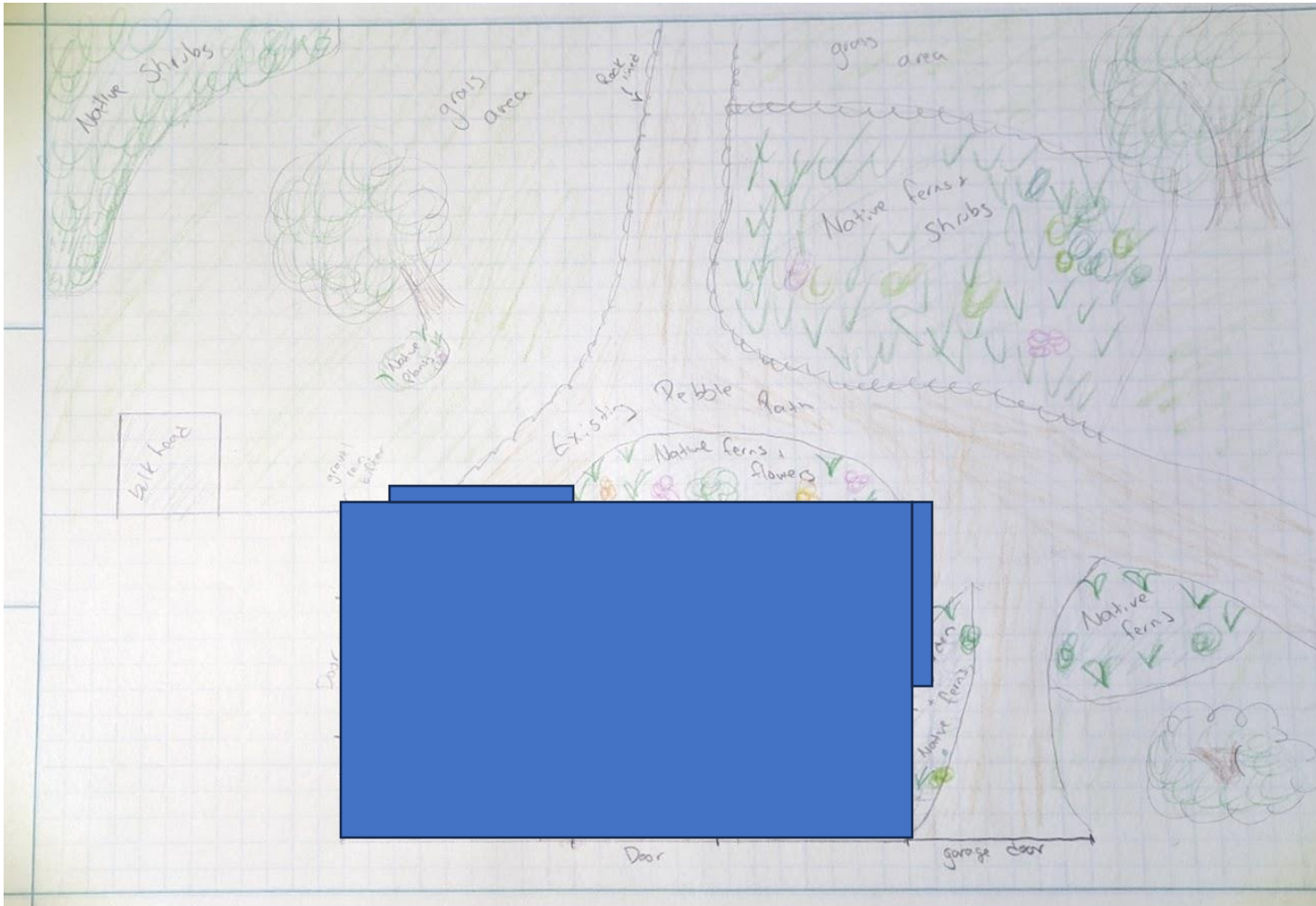

- Box represents deck's footprint





# Proposed Material

**Rumbled StormPave - 4x8 Tumbled Permeable Clay Pavers - Pine Hall  
Brick**



## **Material Description:**

**Rumbled StormPave™** is an amazing breakthrough in water permeable paving. Rumbled StormPave is a Permeable Clay Paver that looks like the classic *English Edge* Clay Paver but with rumbled texture. It has spacers that enable rainwater to go in between the pavers. And instead of being installed atop gravel and sand like conventional pavers, Rumbled StormPave is installed in a best-practices system atop layers of differently sized aggregates. Rainwater goes in between the pavers to the aggregates below, where it is held until it is absorbed into the ground, where it is naturally filtered. Rumbled StormPave pavers are often used to fulfill regulatory requirements of storm drainage in commercial applications. Increasingly, as regulations are being tightened, they are being used in residential areas. Here, they provide an aesthetically pleasing driveway and parking pad, while addressing persistent drainage issues and fulfilling local regulations for residential runoff.

**Rumbled StormPave** 4x8 clay pavers feature beveled edges for crisp clean lines and large spacer bars to provide spacing for washed aggregate filled joints that allow water to drain freely between the paving units. The water then dissipates naturally into the native soils. Less than ½" gaps for ADA Compliance. Initial rate of infiltration of over 500 inches per hour. The dimensions are standard 4"x8" by 2.25" and Heavy Duty 2.75" thickness. The paver complies with ASTM C902, Class SX, Type I, Application PX and ASTM C67 for Freeze/Thaw. All Heavy Vehicular pavers comply with ASTM C1272.

<https://paveroutlet.com/pine-hall-brick-rumbled-stormpave-permeable-clay-pavers>

# Project Representative/Homeowner

Sarah Cook

845-797-3136

[scook26@gmail.com](mailto:scook26@gmail.com)