

FILE NAME: O:\5122 Prescott Park Grant\05 Supporting Documents\01-Drawing\5122-Hydro Survey.dwg LAYOUT NAME: V-101 PLOTTED: Thursday, December 08, 2011 - 4:32pm USER: dmarcotte

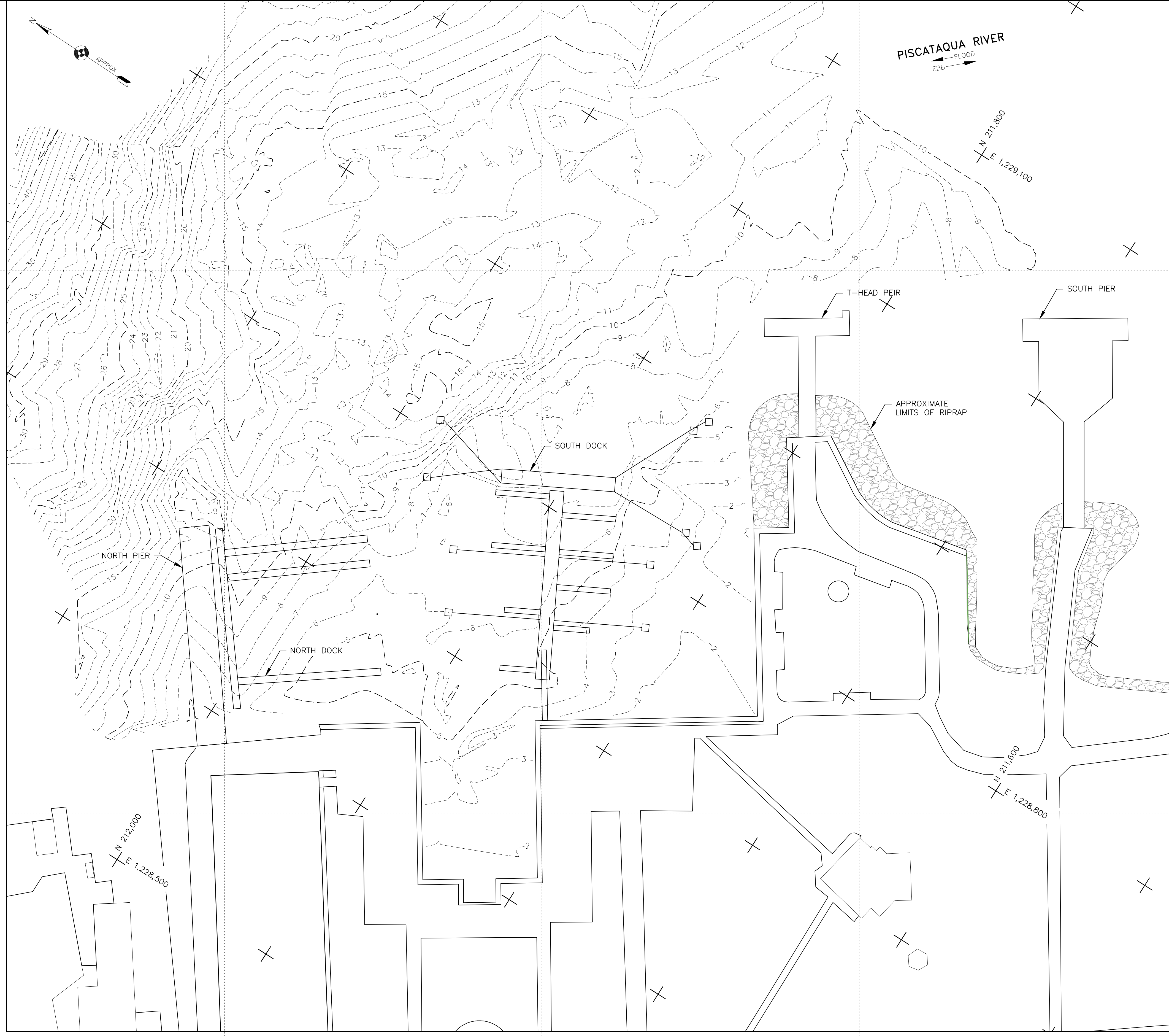

**LEGEND:**  
 --- 6 --- 1 FT CONTOUR  
 --- 5 --- 5 FT CONTOUR

- SURVEY NOTES:**
1. THIS IS A GENERAL RECONNAISSANCE HYDROGRAPHIC SURVEY, AND NOT INTENDED FOR USE WITH NAVIGATION PROJECTS WHERE SHIP CLEARANCES ARE CRITICAL. THE FOLLOWING PERFORMANCE STANDARDS ARE ESTIMATES ONLY. THE BATHYMETRY CAN ONLY BE CONSIDERED AS INDICATING THE CONDITIONS EXISTING AT THAT TIME AT THE LOCATION COVERED ONLY.
  2. CONTOURS DEPICTED HERE WERE GENERATED FROM SHOALEST OBSERVED SOUNDINGS OBSERVED AROUND MARINA.
  3. HORIZONTAL CONTROL: GRID SYSTEM IS IN FEET AND HEREIN AREA BASED ON THE THE NEW HAMPSHIRE STATE PLANE COORDINATE SYSTEM, NAD83
  4. VERTICAL BENCHMARK: DEPTH ARE IN FEET AND ARE REFERENCED TO MEAN LOWER LOW WATER BASE ON NOAA/NOS TIDE STATION ID. 8423898, FORT POINT, NEWCASTLE ISLAND, NEW HAMPSHIRE.
  5. CONTOURS WERE DEVELOPED FROM A HYDROGRAPHIC SURVEY COMPLETED ON JULY 29, 2011 BY APPLIEDORE MARINE ENGINEERING INC., PORTSMOUTH, NH. INDIVIDUAL SOUNDING POINTS ARE SHOWN ON SHEET 2 OF 2 AND WERE USE TO DEVELOPED CONTOURS ON THIS SHEET.
  6. CONTOUR INFORMATION PRESENTED ON THIS DRAWING REPRESENTS THE RESULTS FROM HYDROLITE-TM SONARITE V3.0 (OHMEX INSTRUMENTATION) MAPPING GPS SYSTEM WITH A TRIMBLE GEOEXPLORER GEO XH RECEIVER AND WITH AN ECHOSOUNDER WITH A 4 DEGREE BEAM WIDTH.
  7. CONTOURS ARE IN FEET AND WERE GENERATED USING HYDROLITE-TM SONARITE V3.0 (OHMEX INSTRUMENTATION). DATA WAS POST PROCESSED WITHIN AUTODESK AUTOCAD CIVIL 3D VERSION 2004.
  8. SHORELINE AND ONSHORE FEATURES ARE APPROXIMATE AND WERE TAKEN FROM CITY OF PORTSMOUTH TOPOGRAPHIC MAP SHEET NO. 69, DATED 50-03-94.

**TIDAL DATA:**

	MLLW (FEET) DATUM
HIGH OBSERVED WATER LEVEL (01/02/2010)	= 12.27
MEAN HIGHER HIGH WATER (MHHW)	= 9.40
MEAN HIGH WATER (MHW)	= 8.97
NORTH AMERICAN VERTICAL DATUM (NAVD88)	= 4.99
MEAN SEA LEVEL (MSL)	= 4.69
MEAN TIDE LEVEL (MTL)	= 4.66
MEAN LOW WATER (MLW)	= 0.34
MEAN LOWER LOW WATER (MLLW) (1983-2001 TIDAL EPOCH)	= 0.00
LOWEST OBSERVED WATER LEVEL (03/21/2007)	= -2.56

**REFERENCE:**  
 NOAA/NOS TIDE STATION ID. 8423898, FORT POINT,  
 NEWCASTLE ISLAND, NEW HAMPSHIRE  
 PUBLICATION DATE: 06/18/2010



<p>AMEI PROJECT NO: 5122          CAD FILE NAME: 5122-Hydro Survey.dwg</p>	
DESIGNED BY: DLM	DRAWN BY: DLM
CHECKED BY: RMS	DATE: SEPTEMBER 2011
SCALE: AS SHOWN	
<p><b>Appledore Marine Engineering Inc.</b>          600 STATE STREET          PORTSMOUTH, NH 03801          603.766.1870 am@appledoremarine.com</p>	
<p>ROBERT M. SNOWER          Surveyor          No. 6380          STATE OF NEW HAMPSHIRE</p>	
<p>CITY OF PORTSMOUTH          JOSIE F. PRESCOTT TRUST</p>	
<p>PRESCOTT PARK          PORTSMOUTH, NEW HAMPSHIRE</p>	
<p><b>HYDROGRAPHIC SURVEY</b></p>	
<p>PLAN</p>	
SHEET 1 OF 2	DATE
DATE	APPR
DATE	APPR

FILE NAME: O:\5122 Prescott Park Grant\05 Supporting Documents\01-Drawing\5122-Hydro Survey.dwg LAYOUT NAME: V-102 PLOTTED: Thursday, December 08, 2011 - 4:33pm USER: emarocotte

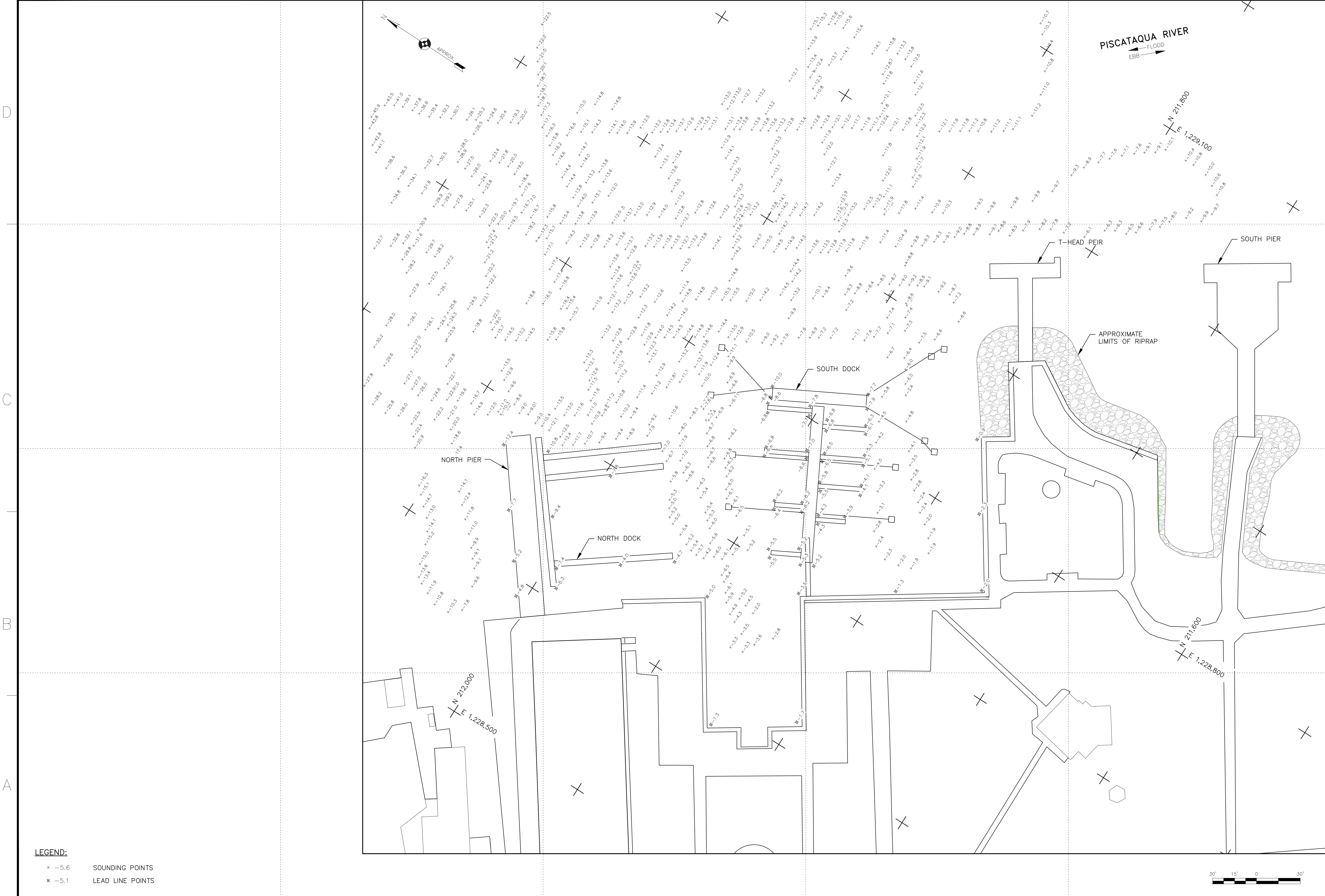

**LEGEND:**  
 x -5.6 SOUNDING POINTS  
 x -5.1 LEAD LINE POINTS



<b>Appledore Marine Engineering Inc.</b> 600 STATE STREET PORTSMOUTH, NH 03801 603.766.1870 am@appledoremarine.com		AMEI PROJECT NO: 5122 CAD FILE NAME: 5122-Hydro Survey.dwg DESIGNED BY: DLM DRAWN BY: DLM CHECKED BY: RMS DATE: SEPTEMBER 2011 SCALE: AS SHOWN
<b>CITY OF PORTSMOUTH</b> JOSIE F. PRESCOTT TRUST PRESCOTT PARK <b>HYDROGRAPHIC SURVEY</b>		SUBMITTED: [Signature] PRESIDENT DATE: SEPTEMBER 2011 TITLE: [Signature]
SHEET 2 OF 2		APPR. DATE

