

Tree Removal Proposal 10 FW Hartford Drive

Project representatives

Ivo & Caitlin van der Graaff
10 FW Hartford Drive, Portsmouth, NH 03801
tel. 5128207790
email: ivovdg@gmail.com

Chris Kemp
Piscataqua Landscaping and Tree Service
26 Maclellan Lane
Eliot, ME 03903
tel. 2074392241
email: ckemp@piscataqualandscaping.com

10 FW Harford Drive was built in 1980. Part of the property sits in protected wetland (see added plan). Since then, the site has seen little in terms of tree management. After 40 years of neglect many trees are now leaning toward the house. Many have their limbs over the or touching the roof. Others are sick and dying whereas some trees are in danger of falling with their root systems exposed.

The aim of this project is to cut down those trees at the edge of the property that directly threaten the integrity of the home. These threats include:

- damage due to possible falling limbs or whole trees
- Humidity due to lack of sunlight and air circulation resulting in moss growth on the roof sides and concrete foundations of the home.

In order to counter these threats, the owners have contacted Chris Kemp, a certified arborist, at Piscataqua Landscaping and Tree Service to assess which trees pose a direct threat to the home and need to be removed. Mr. Kemp has identified fifteen trees on and adjacent to the property that need to be removed in order to safeguard the home. The removal of these trees is essential for our safety. Our approach has been judicious with the aim to have as little impact as possible on the wetland and protect the live trees in the area.

All trees will be removed by hand without or by use of a truck with a bucket. No wheeled vehicles will enter the wetland area.

Given that much of the property lies within designated wetland and its adjacent buffer zone we request a conditional wetland permit to complete the project.

Plan showing the approximate location of the trees to be removed from 10 FW Hartford Drive. See individual description of the trees numbered in the plan.

Shaded green area indicates wetland. Green line outlines the 100 foot buffer zone

Impacted Jurisdictional Areas: inland wetland, inland wetland buffer.

Distance of proposed activity to the edge of wetland: structure is already within the wetland and buffer zone.

Wetland area on property: 5,447 sq. feet.

Wetland area off property: too large to measure.

Wetland area to be disturbed: minimal ca. 450 sq. feet where trees will be removed.

Total buffer zone area on lot: 25,049 sq. feet.

Buffer zone area to be disturbed: ca. 500 sq. feet where trees will be removed.

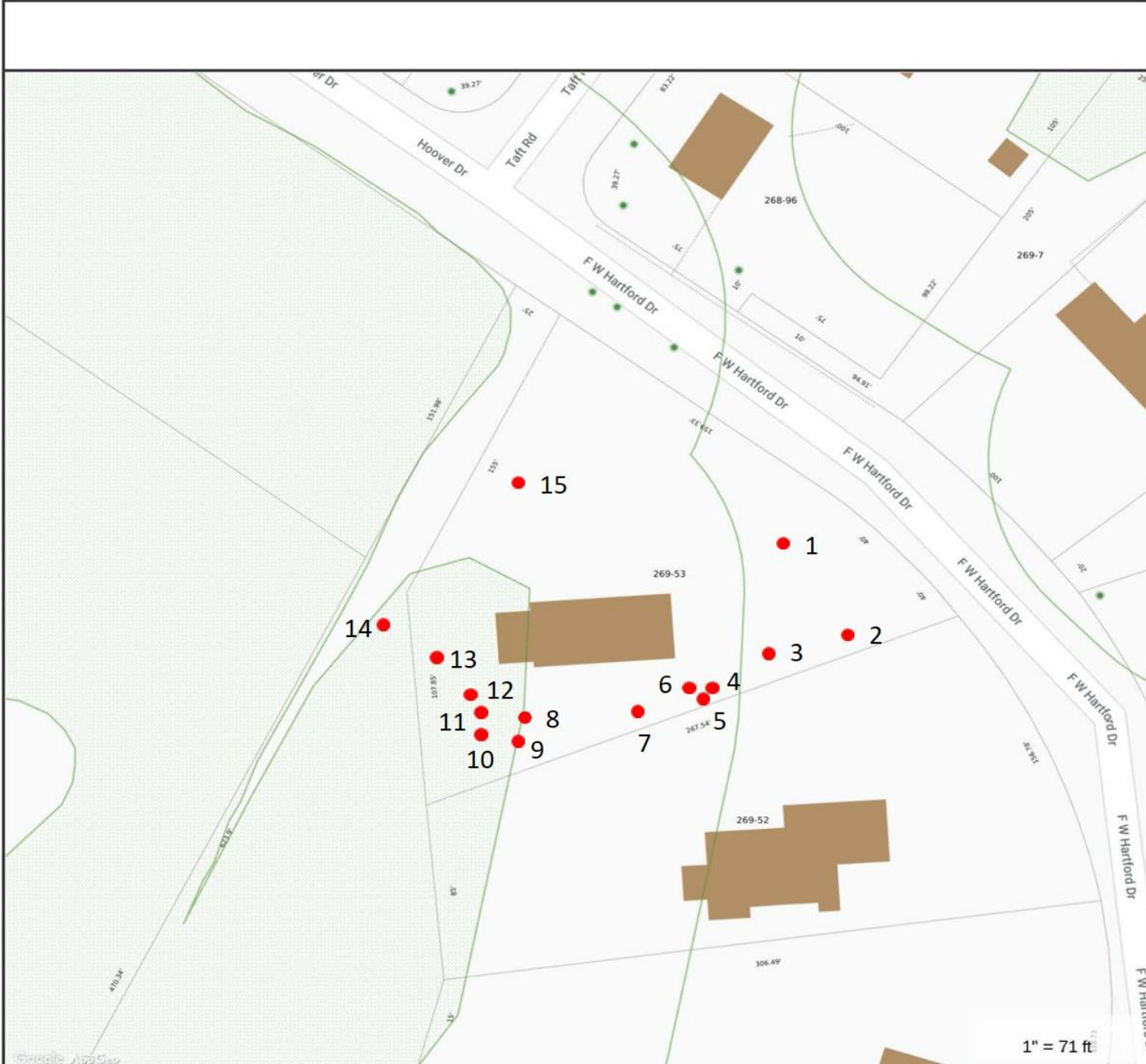



Tree 1

This tree is outside of the wetland and buffer zone. It is struggling and many of its branches are dead or dying



Tree 2

This tree is outside of the wetland and buffer zone. Felling it would help with the light and air circulation to our yard.



Tree 3

This tree is outside of the wetland and buffer zone. Felling it would help with the light and air circulation to our yard.



Tree 4 (background left)and tree 5 (background right)

The branches are dying, and the trees seems sick. Trees can fall on to the property if not removed.



Tree 6

This tree exhibits dangerously exposed roots. It is unstable and threatens to fall on the propane tanks and the house located behind the photograph.



Tree 7

This tree leans dangerously over the house. It is in danger of snapping or falling onto the house.



Overview trees 8-13 and their position relative to the back of the house.



Trees 8 and 9

These two trees lean toward the house with their limbs almost touching the roof. Their removal would improve safety as well as air circulation to prevent moss growth on the concrete foundation, roof, and siding



Trees 10, 11, and 12

These three trees lean toward the house with their limbs almost touching the roof. Their removal would improve safety as well as air circulation to prevent moss growth on the concrete foundation, roof, and siding.



Tree 13

The top of this tree snapped off many years ago prior to us moving here. Its limbs almost touch the house. Any further pruning will almost certainly kill it. Better to remove it before it dies and threatens the house.

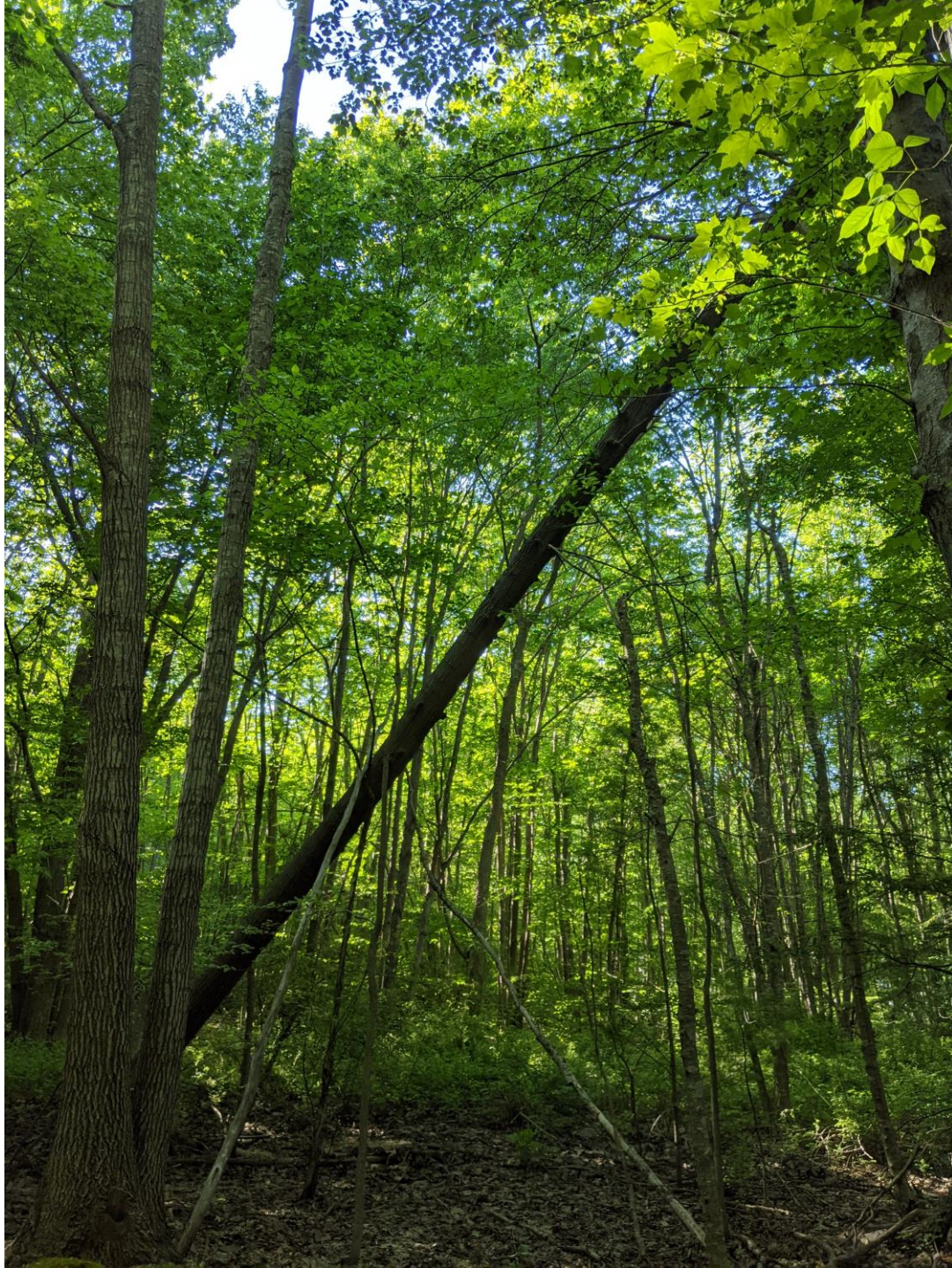

Tree 14

This tree leans heavily toward the back of the house and uses several other trees to hold it up. Its roots are heavily exposed. Given its size and instability it threatens to take several other trees with it when it falls.



Tree 15

This is a dead tree in the buffer zone that has lost all its branches. It needs to be removed to prevent it from falling over on the property.